

THE WALL[®]

A NATIONAL LANDMARK OF HOPE

IN ASSOCIATION WITH

RIBA 

THE WALL OF ANSWERED PRAYER

Designed by Snug Architects

“AN ICONIC LANDMARK
COMMUNICATING THE VALUE
OF PRAYER TO THE VISUAL
AGE OF THE 21ST CENTURY”



The Wall will be a piece of public art built of one million bricks, with each brick linked to an answered prayer.

We aim to:

- Preserve our nation's Christian heritage
- Inspire the nation to pray
- Reveal how and why Jesus answers prayer

On-site:

- Bespoke app to access answered prayers on bricks
- State-of-the-art educational exhibition on prayer
- Interactive touch screens to access answered prayers on bricks
- 24/7 Prayer Room
- Café and Christian bookstore
- Park area for prayer and reflection
- Trained chaplains providing support



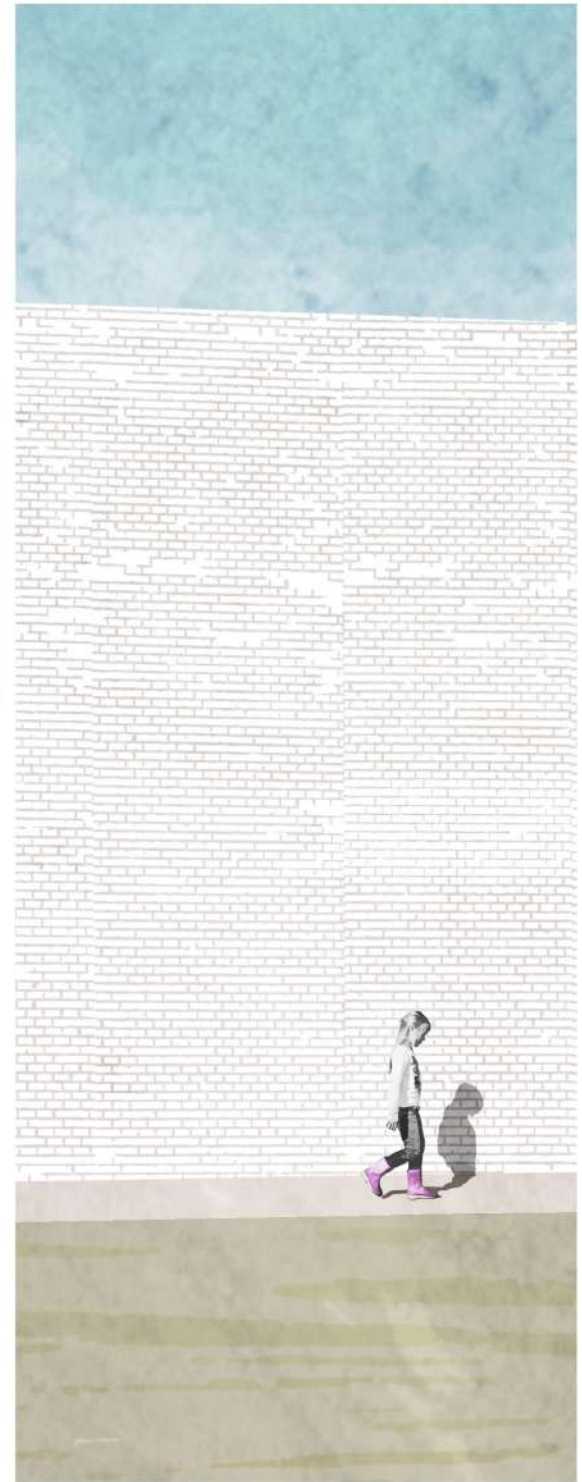
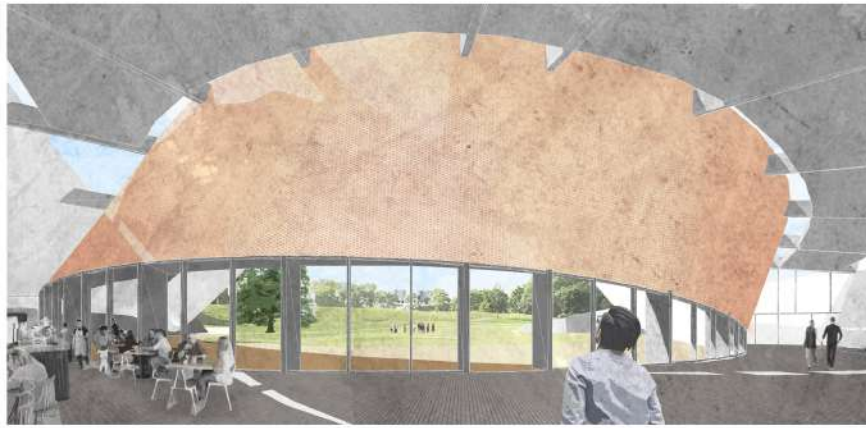



DESIGNED BY
snugarchitects



The background of the slide features a large, textured wall on the left side, rendered in shades of grey and blue. To the right of the wall, a large, leafy green tree stands in a grassy field under a light blue sky. The overall composition is split diagonally by the wall.

PUBLIC ART TO INSPIRE THE GENERATIONS TO COME

The Wall will share answered prayers for hundreds of years, providing a source of hope for the generations to come.

Visitors will be able to find answered prayers that relate to the storms of life that they may be experiencing. They will be able to see how God has responded to people similar to them and be given hope to find the God who answers.

Answered Prayer #10830 – My father had a massive stroke little more than a month ago. The doctor said it was the worst he had seen. He told me to prepare myself, because if he lives he will be brain dead. Well I'm here to say my God is awesome... My father is talking, he's alert, he is not brain dead, and they can't explain it.

“ONLY BE CAREFUL, AND
WATCH YOURSELVES CLOSELY
SO THAT YOU DO NOT FORGET
THE THINGS YOUR EYES HAVE
SEEN OR LET THEM FADE FROM
YOUR HEART AS LONG AS YOU
LIVE. TEACH THEM TO YOUR
CHILDREN AND TO THEIR
CHILDREN AFTER THEM”
– DEUTERONOMY 4:9

"I THINK IT WILL MAKE A BIG IMPACT ON THE NATIONAL CONSCIOUSNESS. IT'S A REFLECTION OF THE FACT THAT MANY, MANY PEOPLE IN BRITAIN TODAY, AS WELL AS IN OUR HISTORY, HAVE EXPERIENCED ANSWERED PRAYER..."
- Stephen Timms MP



VISITOR EXPERIENCE

“VISITORS WHO HAVE BEEN INTRIGUED BY THE ARCHITECTURE WILL BE WOWED BY THE INTERACTION ON-SITE”

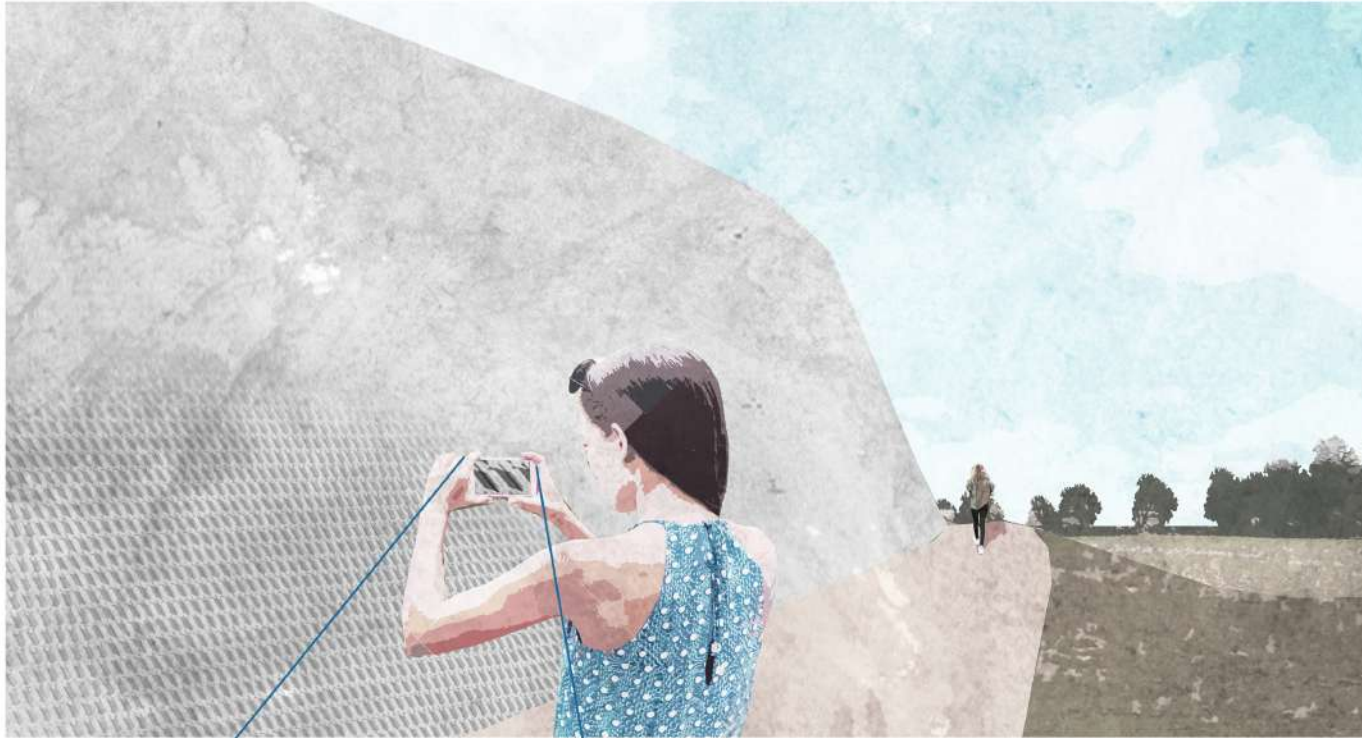

There will be an app available that will display an answered prayer whenever visitors hold their phone up to a brick. Visitors will interact with the answered prayers through:

The app will take them on a journey uniquely crafted for them by highlighting specific answered prayers relevant to their interests.

Touch screens will allow visitors to type in a situation and read the associated answered prayers.

Tourist binoculars will zoom in on bricks that are out of reach and display the linked answered prayers.

People who have shared an answered prayer with The Wall will be led to find their own brick in the monument.

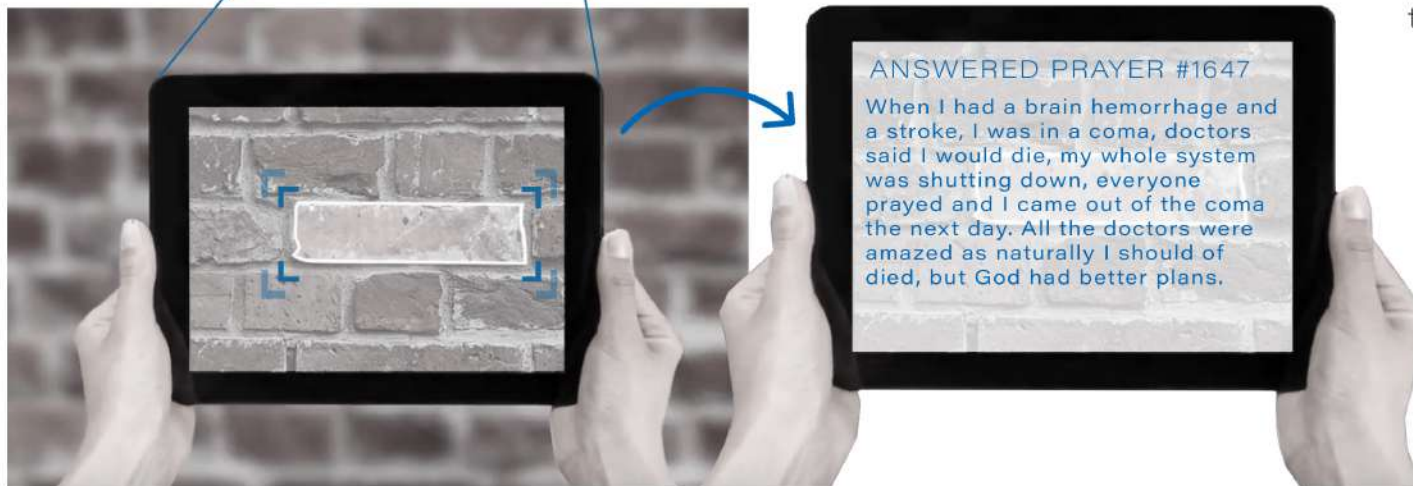

A PLACE OF PRAYER + REFLECTION

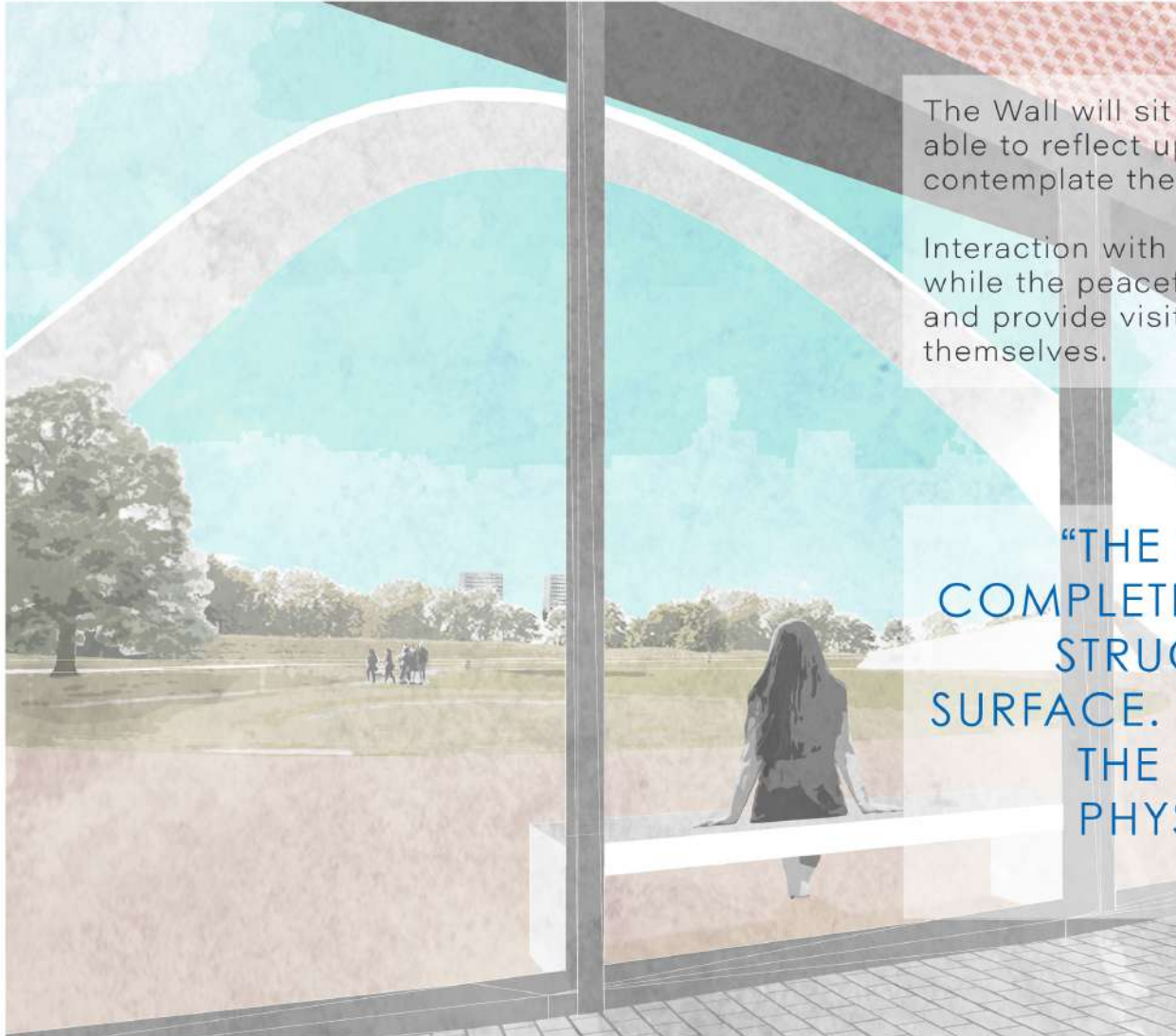

The Wall will sit upon ten acres of beautiful landscape. Visitors will be able to reflect upon both manmade and natural beauty as they contemplate the answered prayers they have discovered.

Interaction with the monument will be stirring and thought-provoking, while the peacefulness of the landscape will allow for quiet reflection and provide visitors with the space to experience prayer for themselves.

“THE LAYOUT ENCOURAGES VISITORS TO COMPLETE A CIRCULAR PROMENADE OF THE STRUCTURE, VIEWING EVERY PART OF ITS SURFACE. WALKING IN, UNDER AND AROUND THE STRUCTURE PROVIDES A RANGE OF PHYSICAL, EMOTIONAL AND AESTHETIC ENCOUNTERS WITH THE BRICKS”

EXHIBITION

An exhibition space built into The Wall itself will inform visitors on what Christians believe about prayer. Leaders of other faiths will also have the opportunity to share what they believe. This teaching will align with the national RE curriculum, encouraging school trips to visit.

Important dates and themes will be explored through a revolving exhibit, allowing for specific moments of significance to be explored, such as Remembrance Day, Awareness Days etc.



EXHIBITION

RECEPTION

ENTRANCE HALL

CAFÉ

VISITOR CENTRE

HERITAGE BRICKS

"THE ISRAELITES LAID STONES TO REMEMBER WHAT GOD HAD DONE IN THEIR NATION... WE WILL LAY BRICKS - PRESERVING OUR COUNTRY'S CHRISTIAN HERITAGE."

The Wall will contain 75,000 historical answered prayers that preserve the nation's rich Christian heritage. Visitors will be able to discover the power of prayer through stories from the past two millennia.

Answered Prayer #300113

"In May 1940 when France had fallen and the British Army was trapped at Dunkirk where they were to be annihilated, King George VI called for a National Day of Prayer to plead for Divine Intervention. So widespread and so deep was faith in God that literally millions of people flocked into churches to pray...

There was Dunkirk and its flat calm sea. Who planned that? We saw no way out barring a miracle. Then came the miracle...

When you read the reflections of those who were in authority, individuals who had direct knowledge as to what really happened behind the scenes during the War, they all describe the same thing. An overwhelming sense of Divine Intervention at critical moments."

- Wartime Miracles

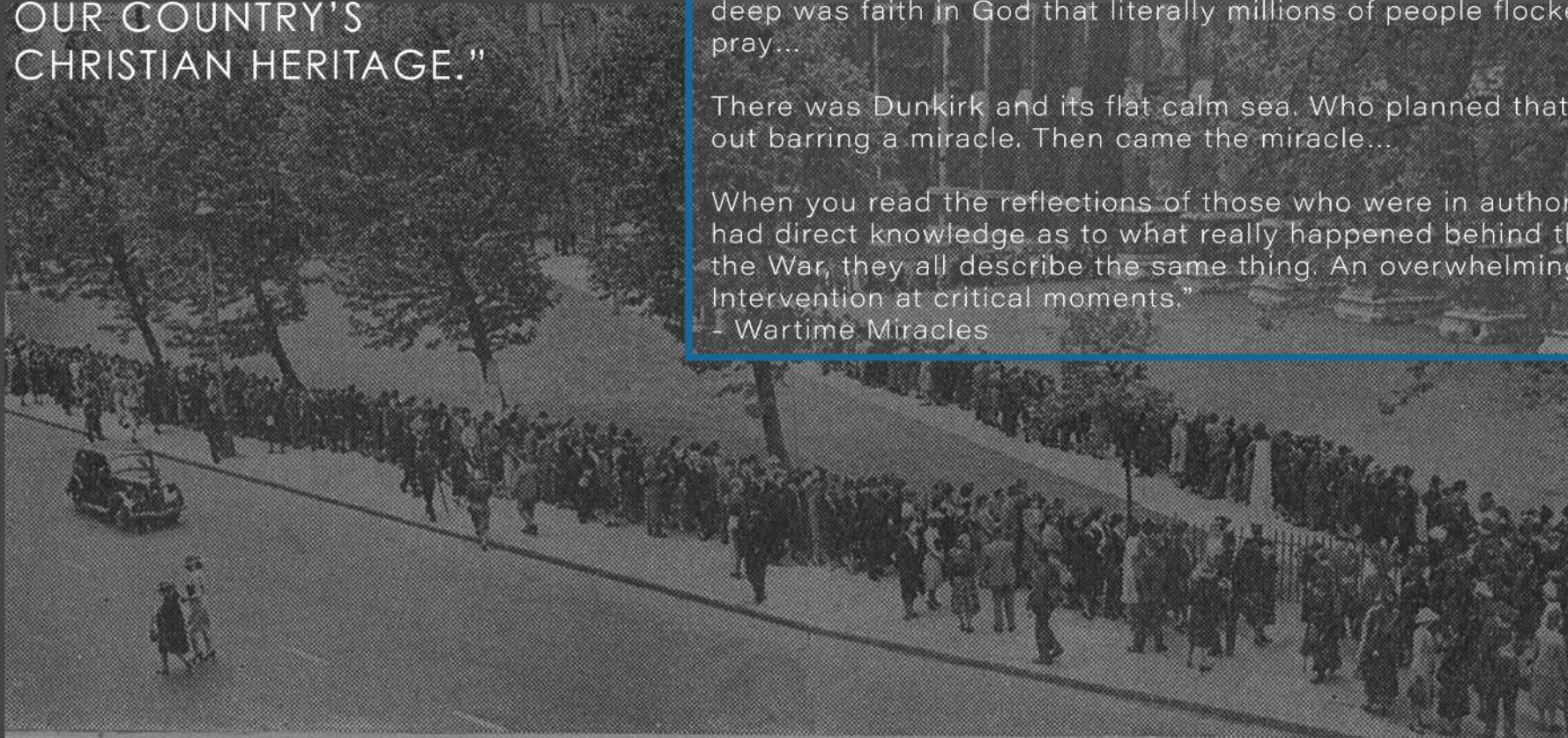

“THIS WILL BE THE FIRST NATIONAL LANDMARK GLOBALLY THAT HAS NOT ONLY BEEN CROWDFUNDED AND CROWD-RESOURCED, BUT ALSO CROWD CREATED.”

Although the physical monument will be built by a team of experts, the meaning of The Wall will be created by the million people who contribute their answered prayers.

Breaking down the million answered prayers:

- 700,000 from the UK
- 75,000 historical
- 1,000 biblical
- 224,000 from overseas

We expect to have around 150,000 answered prayers once building is completed in 2022. Though The Wall of Answered Prayer will be physically built, the spiritual piece of public art will continue to develop for many years.

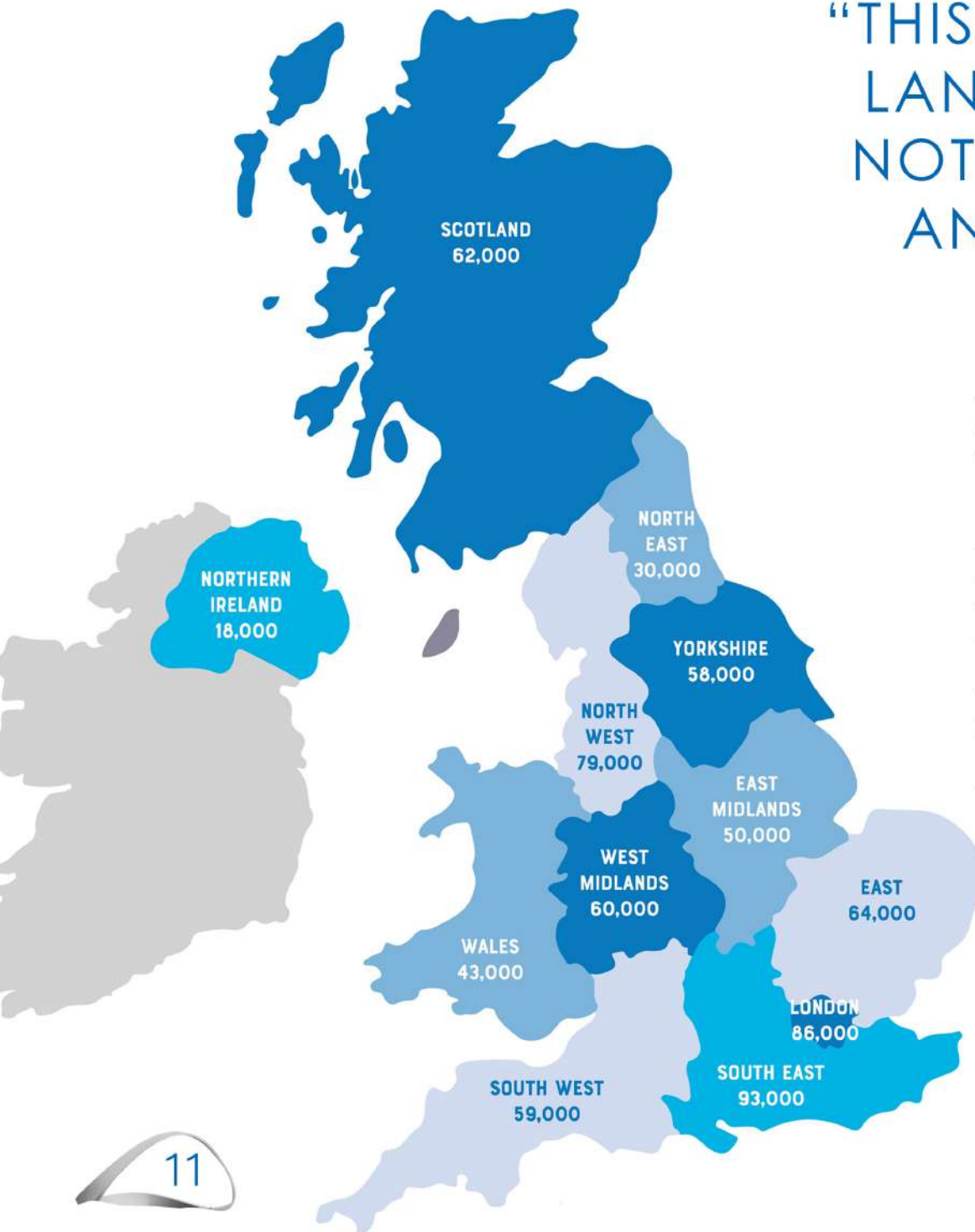

TIMELINE

SO FAR...



WHAT'S NEXT...

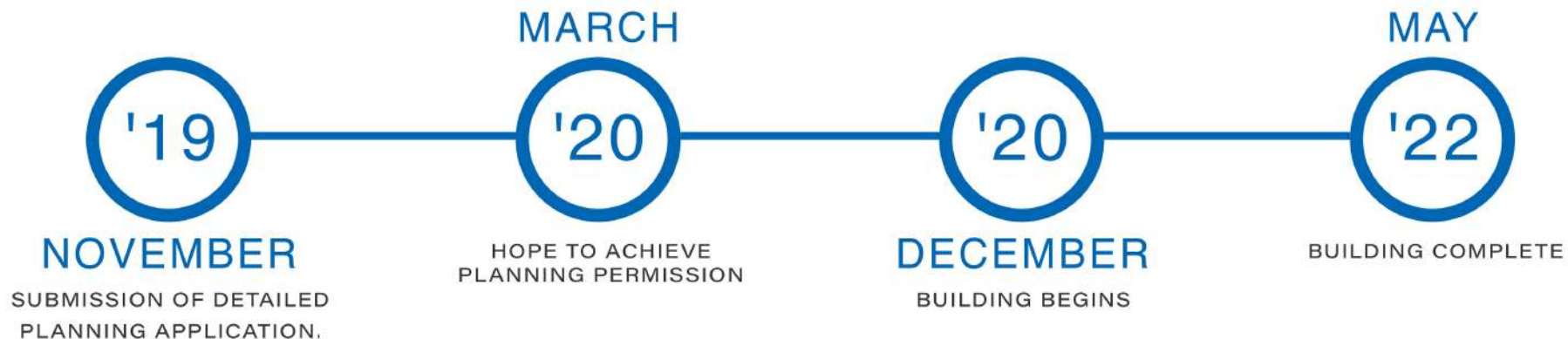

FINANCIALS

The overall budget for this project is £10 million which includes the build, provision for maintenance, & giving to social housing. Once planning consent is achieved we will seek to crowdfund £1m with the remainder match-funded by individuals and trust funds.

The budget for the next phase to achieve planning is £384,000.

Entry to The Wall will be free but by generating income through the car park, bookstore, and donations, we expect once fully operational to generate a net profit of £400k a year, which will be invested into UK charities.

PRE- CONTRACT DUE DILIGENCE		PROFESSIONAL FEES (PRE CONTRACT)	
Ground conditions incl contamination	15,000	Architect	94,800
Archaeological	4,000	Structural Engineer	7,500
Flood Risk Assessment	5,000	CDM Consultant	5,000
Traffic / Aviation / Highways	14,500	Land Agent	2,500
Arboricultural & Ecological surveys	4,800	Project Management	26,000
SUB TOTAL	43,300	SUB TOTAL	135,800
PLANNING		OTHER	
Planning strategy and support	50,000	Planning Fee	19,000
Landscape strategy	5,000	Planning conditions	75,000
Consultation	8,000	Tax advice	8,000
Services due-diligence	5,000	Political engagement	20,000
Legal	15,000	SUB TOTAL	122,000
SUB TOTAL	£83,000	GRAND TOTAL	384,100

We have travelled a long way to get to this point and the miracles of provision have been amazing. We now have before us an incredible opportunity to realise a Christian national landmark to be built in the heart of our nation.

It will last for hundreds of years and will remind millions of God's deeds in this nation, both presently and throughout our history.

We have, I believe, a once-in-a-lifetime opportunity to preserve this nation's Christian heritage for perpetuity.

Let us respond to this challenge and opportunity, so that those who follow will know that God will hear their cries, will listen, and will answer.

**“PLEASE GIVE GENEROUSLY AND BE
A PART OF MAKING HISTORY FOR
GENERATIONS TO COME.”**

BACS Details for The Wall of Answered Prayer:

Bank Name: Santander
Account Name: The Wall of Answered Prayer
Sort Code: 090222
Account No: 10589140

RICHARD GAMBLE, CEO

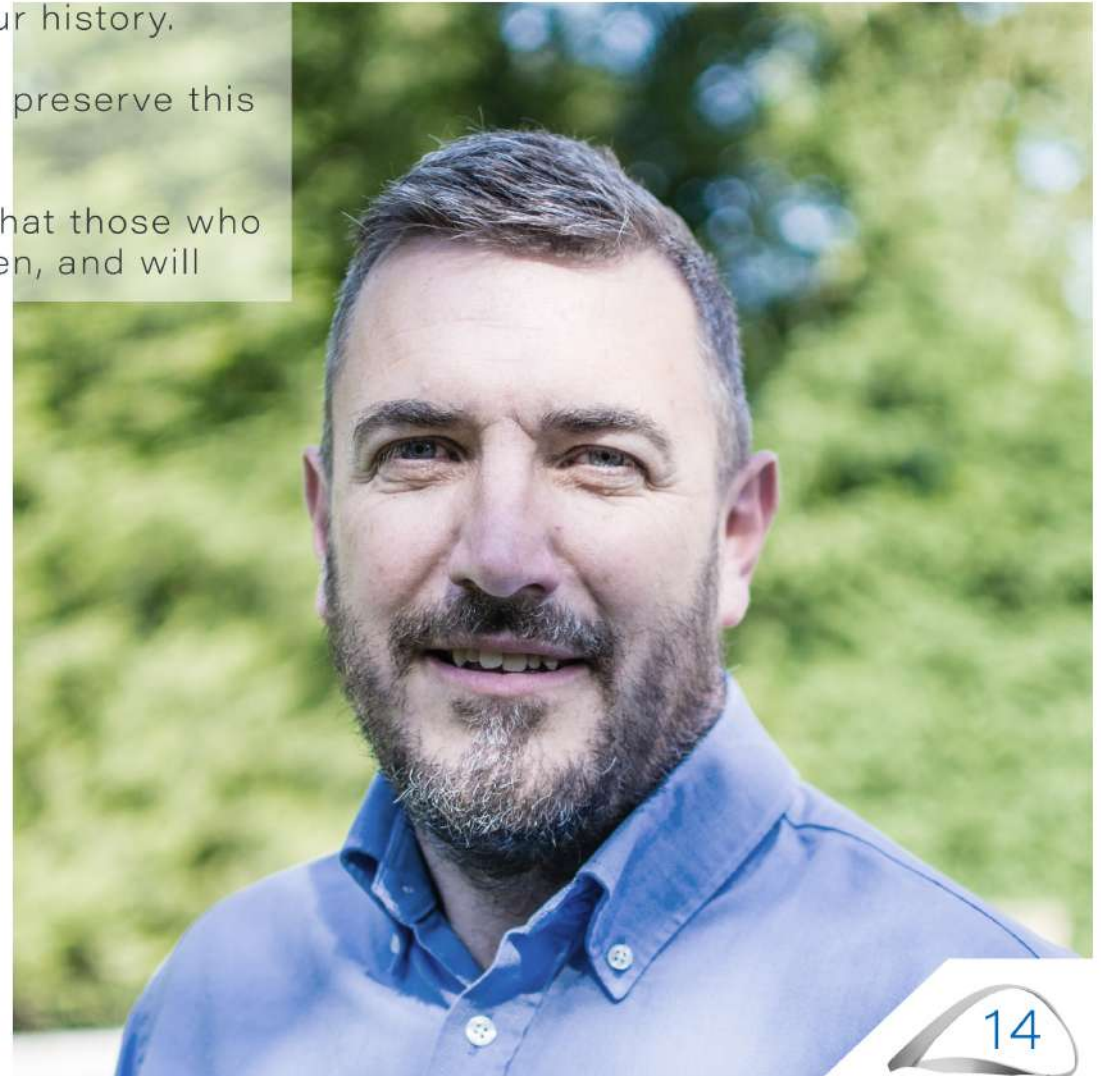

BE?

The Wall will be built on the land surrounding Coleshill Manor. With visibility from up to six miles away, it will be seen from the M6, M42, M6 Toll and HS2.

Flights to and from Birmingham International Airport will also have great views of The Wall from every angle.

“THE STORY OF HOW WE
ACQUIRED THE LAND IS
UTTERLY INCREDIBLE AND
DISPLAYS GOD’S FAVOUR
TO THIS WORK”

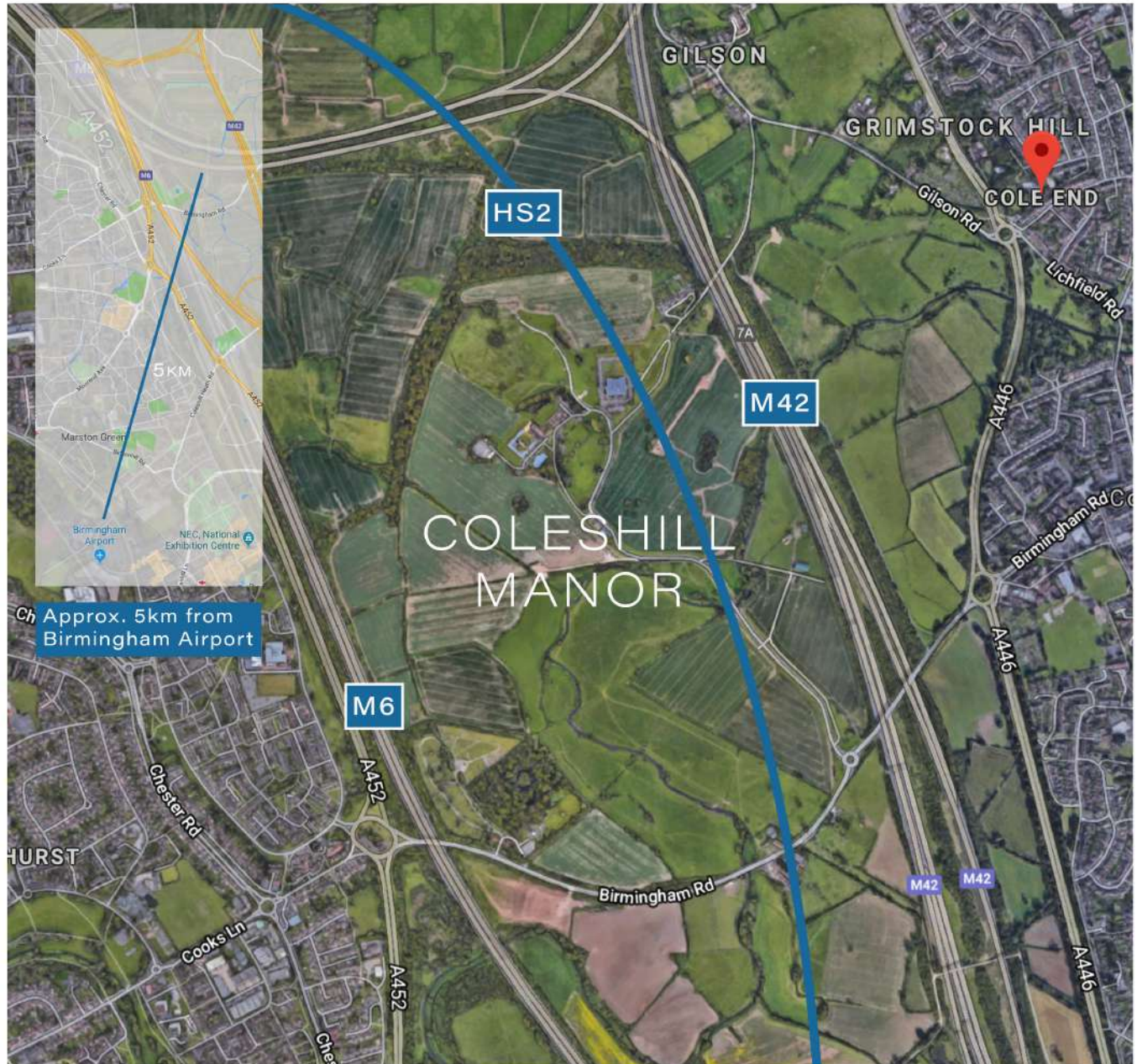

**“500,000
JOURNEYS
WILL SEE
THE WALL
EVERY
WEEK”**



View from the air

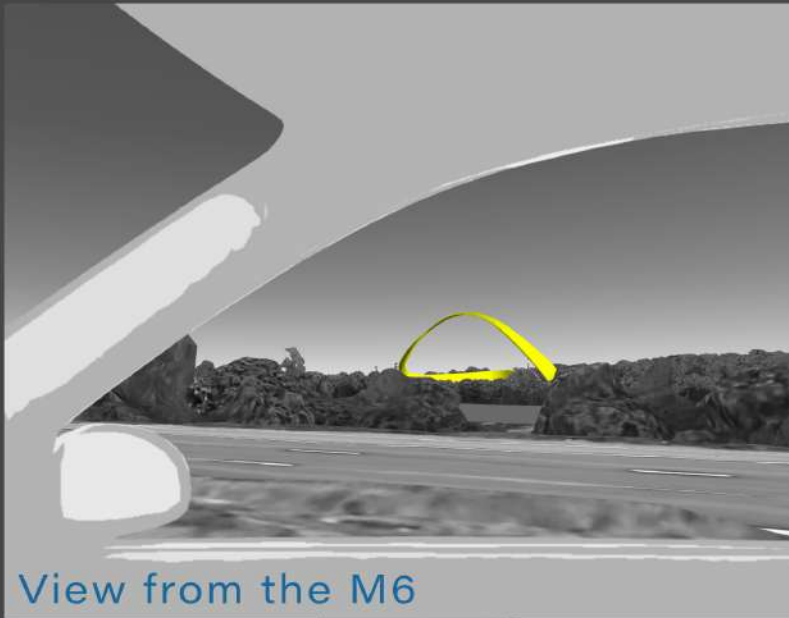

View from the M6



View from HS2

SOCIAL HOUSING + ECONOMIC IMPACT

Social Housing

Once The Wall is completed, profits raised from its ongoing operation will fund a million bricks worth of social housing. This will provide enough finance to build 100 houses for:

- Social action charities
- Council housing associations
- International social housing charities

Economic Impact

The team behind the Angel of the North estimate that the landmark has generated over £500 million for the local economy. This impact is attributed to two key elements:

- An uplift in the sponsorship of nearby public art installations
- An increase in local business investment

We anticipate a similar economic impact from The Wall.

We estimate that The Wall will attract 150-200,000 visitors annually which shall also be of benefit to the local economy.



PARTNERS



CORPORATE PARTNERS



THANK YOU

BE A PART OF MAKING HISTORY FOR THE GENERATIONS TO COME

WHERE TO FIND US?



Search: the wall of answered prayer

THEWALL.ORG.UK